

تقرير مقدم للسيد الأستاذ الدكتور /
وكيل الكلية لشئون التعليم والطلاب
عن النشاط المقدم من
طلاب الفرقة الثالثة (2017-2018)
بكلية الطب البيطري

تحت إشراف

الساده أعضاء هيئه التدريس - تربيه وأنتاج
الدواجن

قسم رعايه الحيوان وتنميه الثروه الحيوانيه

1. Poultry Farm Maquette.
2. Hatcher Maquette.

STAFF SUPERVISION:

Prof.Dr /Mohammed Sharaf
Ass. Prof. / Heba Basha

Ass. Prof / Ayman E. Taha
Dr/ Magda Abosamaha

STUDENTS MEMBERS

Scientific committee members:

Mohamed Amin
Karim Alaa

Outline Designing:

Shahenda Saeed (outline designing)
Marwa Abd El-Maged El Kady (outline designing)
Aly El-Deen Galal (interior designing)
Nourhan Mahmoud
Mohamed Ibrahiem Sheta
Nourhan Mahmoud

Performed by:

Nourhan Mahmoud
Mohamed Ibrahiem Sheta
Shahenda Magdy
Shahenda Saeed
Reem Rageb
Amira Ahmed
Basant Ahmed

1. POULTRY FARM MAQUETTE.

- General Layout:

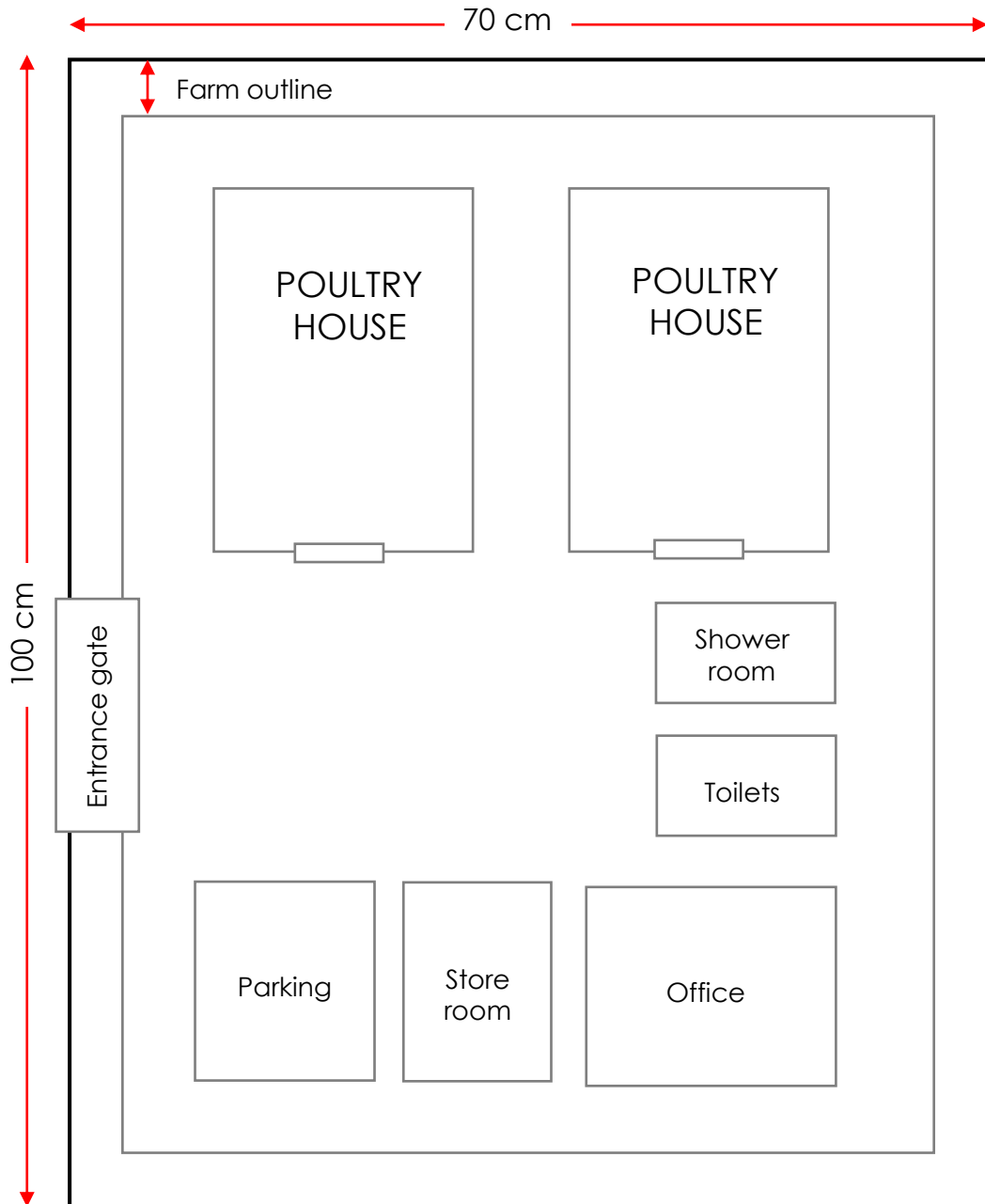

* Biosecurity System

1. POULTRY FARM MAQUETTE.

- Captured photos:

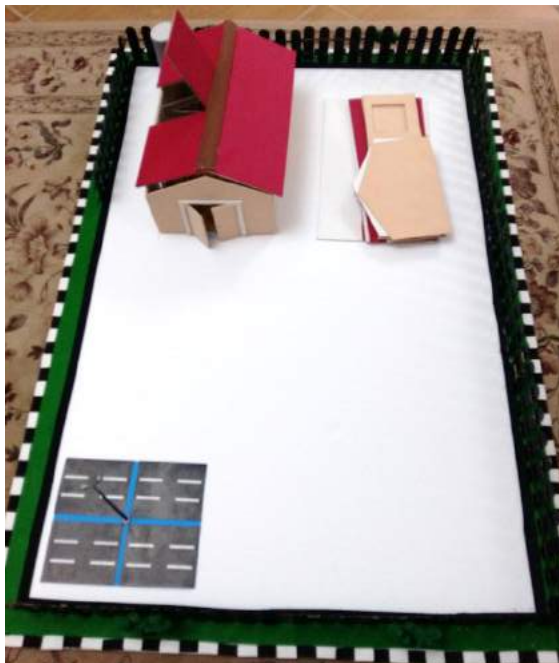

1. POULTRY FARM MAQUETTE.

- Final photos:

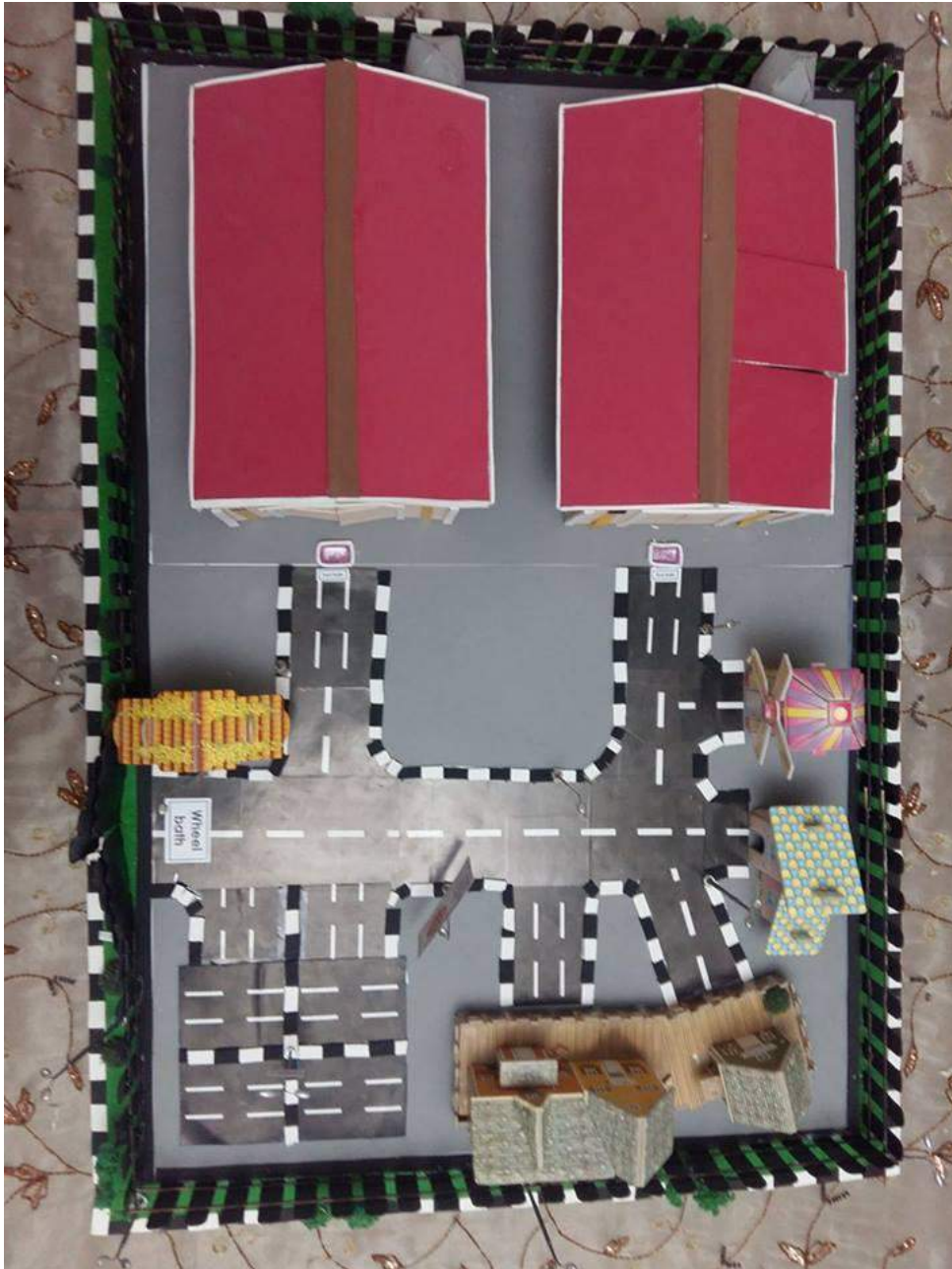

2. HATCHER MAQUETTE.

- General Layout:

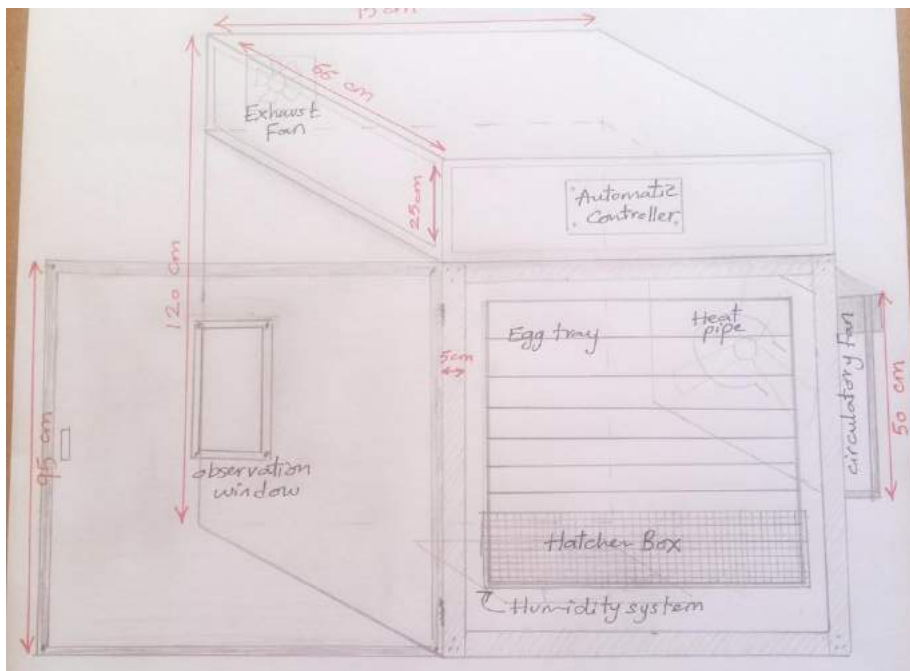
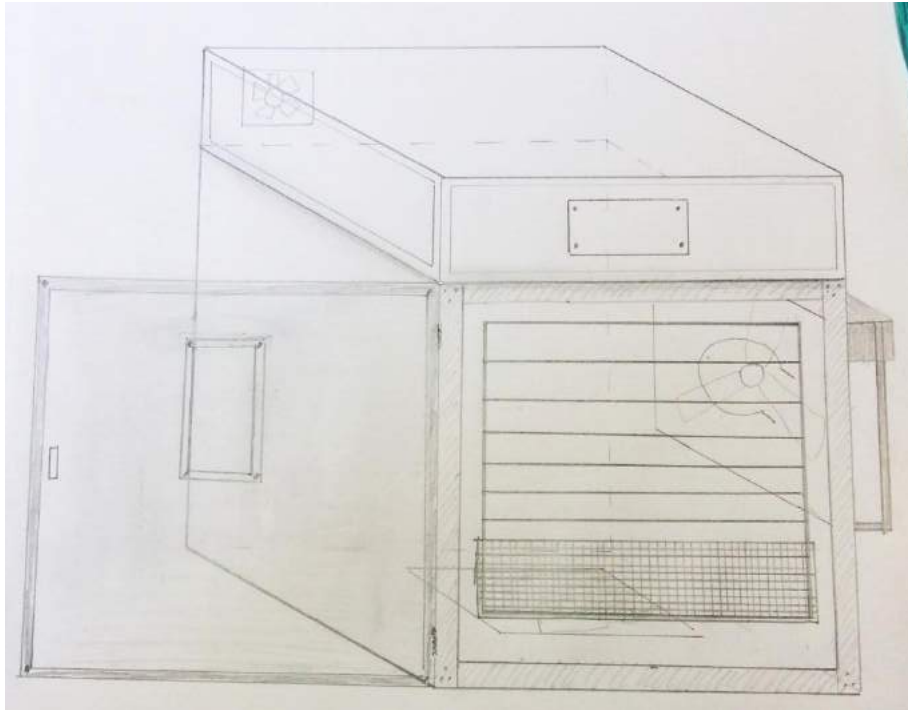

2. HATCHER MAQUETTE.

- Captured photos:



2. HATCHER MAQUETTE.

- Final photos:



- **Materials**

- Photo foam
- Photo hall
- Foam
- Cartoon
- Stickers

- **Time taken:**

- 2 days for outline and interior designing.
- 3 days for buying material
- 3 days for finishing 2 Maquette

POULTRY ACTIVITY



